

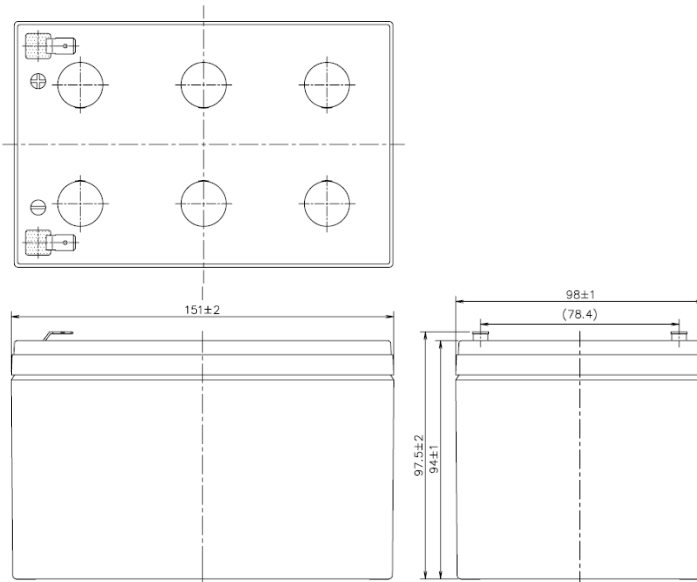

閥調式鉛酸蓄電池(VRLA)
Valve Regulated Lead Acid Battery

REC12-12

尺寸 DIMENSION



規範 Specification

- 公稱電壓 Nominal Voltage : 12V
- 操作溫度範圍 Operating Temperature Range
 - 放電 Discharging -15°C to 45°C
 - 充電 Charging -15°C to 45°C
 - 放置 Storage -15°C to 45°C
- 尺寸 Dimension
 - 長度 Length : 151±2mm
 - 寬度 Width : 98±1mm
 - 高度 Case Height : 94±1mm
 - 總高 Overall Height : 97.5±2mm
- 期待循環壽命 Expected Cycle life (25°C) : 50% DOD 600 Cycle
- 重量 Weight (約 Approx.) : 4.2 kg
- 容易保養 Easy Maintenance
 - 不會洩漏電解液 No electrolyte leakage
 - 確保操作上安全性 Ensure safe and efficient operation
- 公稱容量 Nominal Capacity : 12AH / 20HR (25°C)
- 電槽材質 Container Material :
 - 難燃等級UL94HB Flame class : UL94HB
- 內部抵抗 Internal Resistance(Approx.) : 約 11.8 mΩ
- 用途 Applications :
 - UPS 不斷電系統、電信、緊急照明、警報系統、儀器、太陽能發電系統
 - UPS(Uninterruptible Power Supply)、Telecommunications、Emergency lighting、Alarm systems、Instrumentation、Solar powered systems
- 最大充電電流 Max. Charge current : 3A
- 5 秒最大放電電流
 - Max. Discharge current in 5 seconds : 180A
- 浮動充電 Float Charging : 13.65±0.15V (25°C)
- 循環充電 Cycle Charging : 14.4~15.0V (25°C)
- 端子 Terminal :
 - 插入式端子 Faston tab : 250

REC12-12 性能規格 PERFORMANCE SPECIFICATION : 安培 Amperes and 瓦特 Watts at 25°C (77°F)

F.V.	TIME	3M	5M	6M	8M	10M	15M	30M	1H	2H	3H	5H	10H	20H
10.80V	W	577	505	481	405	368	282	170	98.8	54.2	38.7	25.4	13.42	7.25
	A	51	44	42	35	32.6	24.5	14.7	8.46	4.53	3.24	2.10	1.10	0.61
10.50V	W	651	550	516	434	390	292	175	100.2	54.7	39.1	25.7	13.51	7.29
	A	59	49	46	38	34.7	25.5	15.1	8.57	4.63	3.31	2.16	1.13	0.61
10.20V	W	699	576	535	450	400	297	177	101.2	55.1	39.4	25.8	13.58	7.32
	A	64	52	48	40	35.6	25.9	15.3	8.66	4.68	3.34	2.18	1.14	0.61
10.02V	W	721	588	543	457	404	299	178	101.7	55.5	39.7	26.0	13.71	7.40
	A	67	53	49	41	36.0	26.1	15.4	8.70	4.71	3.37	2.20	1.15	0.62
9.60V	W	755	605	554	466	408	302	179	102.2	55.9	39.9	26.3	13.84	7.47
	A	71	55	50	42	36.4	26.4	15.5	8.74	4.75	3.39	2.22	1.16	0.62

特性 Characteristics

放電特性 DISCHARGE CHARACTERISTICS

放電曲線 Discharge Characteristics Curves at 25°C

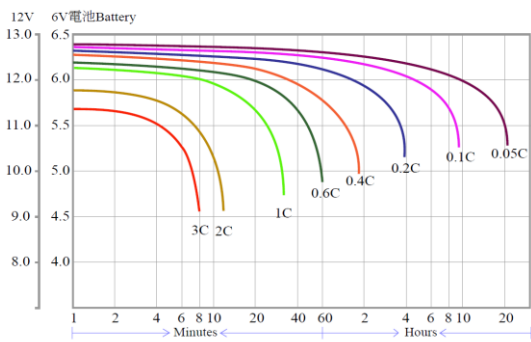

循環壽命特性 CYCLE LIFE CHARACTERISTICS

放電深度與循環壽命關係圖
Cycle Service Life in Relation to Depth of Discharge

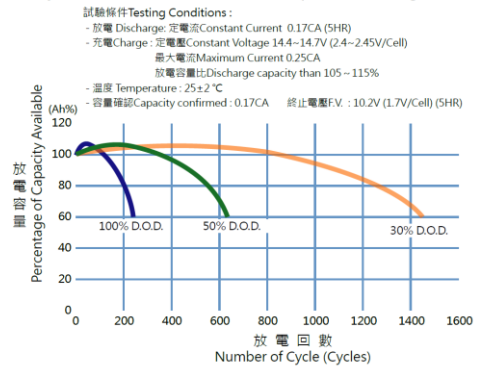

充電特性 CHARGE CHARACTERISTICS

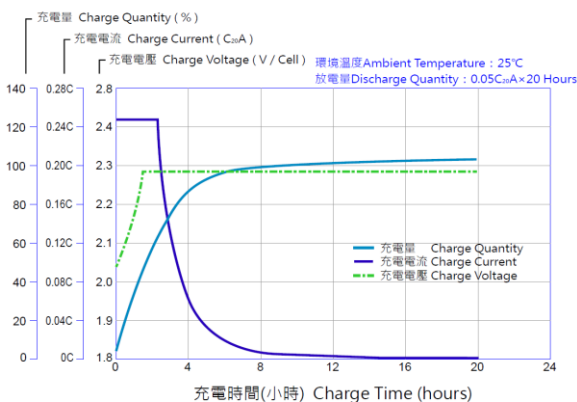

充電電壓 CHARGE VOLTAGE

溫度與充電電壓關係
Relationship Between Temperature and Charge Voltage

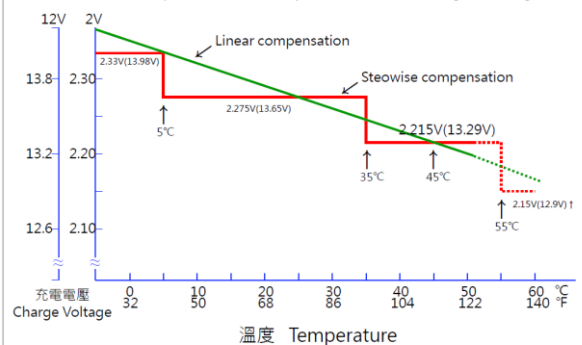

臺灣湯淺電池股份有限公司 新北市新莊區福營路 227 巷 11 號 TEL:(02)2901-8261 FAX:(02)2903-9626
TAIWAN YUASA BATTERY CO.,LTD No.11, Ln. 227, Fuying Rd., Xinzhuang Dist., New Taipei City <http://www.yuasa.com.tw/>