

FXH45-12I FR

尺寸 DIMENSION

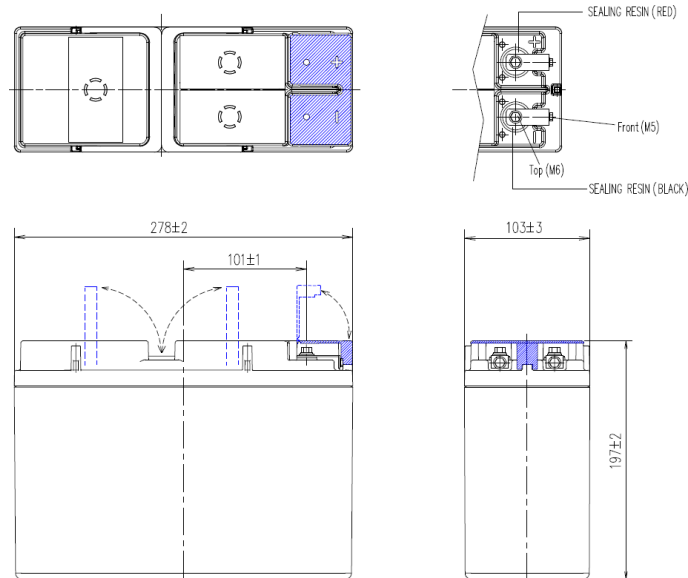

規範 Specification

<ul style="list-style-type: none"> 公稱電壓 Nominal Voltage : 12V 尺寸 Dimension <ul style="list-style-type: none"> 長度 Length : 278±2mm 寬度 Width : 103±3mm 高度 Case Height : 197±2mm 總高 Overall Height : 197±2mm 重量 Weight (約 Approx.) : 15 kg 公稱容量 Nominal Capacity : 45AH / 8HR (25°C) 內部電阻 Internal Resistance(Approx.) : 約 4.7 mΩ 最大充電電流 Max. Charge current : 11.25A 5秒最大放電電流 Max. Discharge current in 5 seconds : 270A 浮動充電 Float Charging : 13.65±0.15V (25°C) 端子 Terminal : <ul style="list-style-type: none"> 極柱端子 Top terminal : 螺絲式 Bolt (M6) 引出端子 (L型連接桿) Front terminal : 螺絲式 Bolt (M5) 	<ul style="list-style-type: none"> 操作溫度範圍 Operating Temperature Range <ul style="list-style-type: none"> 放電 Discharging -15°C to 45°C 充電 Charging -15°C to 45°C 放置 Storage -15°C to 45°C 期待浮充壽命 Expected float use life (25°C) : 10 years 容易保養 Easy Maintenance <ul style="list-style-type: none"> 不會洩漏電解液 No electrolyte leakage 確保操作安全性 Ensure safe and efficient operation 防爆設計 Vent plug provided with built-in ceramic filter <ul style="list-style-type: none"> 阻隔外部火源防止電池破裂 Prevent explosion from outside source of ignition 電槽材質 Container Material : <ul style="list-style-type: none"> 難燃ABS Flame Retardant ABS · 難燃等級 Flame class : UL94V0 氧氣指數 Oxygen index : 28.0% LOI 把手設計 Handle Including 用途 Applications : <ul style="list-style-type: none"> UPS 不斷電系統、電信、緊急照明、警報系統、儀器、太陽能發電系統 UPS (Uninterruptible Power Supply)、Telecommunications、Emergency lighting、Alarm systems、Instrumentation、Solar powered systems
---	--

FXH45-12I FR 性能規格 PERFORMANCE SPECIFICATION : 安培 Amperes and 瓦特 Watts at 25°C (77°F)

F.V.	TIME	15M	20M	30M	45M	1H	2H	3H	4H	5H	8H	10H	20H
		W	A	W	A	W	A	W	A	W	A	W	A
10.80V	W	949	815	612	449	360	206	148	116	96.2	65.5	53.4	27.7
	A	83.8	71.5	53.2	38.6	30.8	17.4	12.4	9.67	8.03	5.46	4.50	2.34
10.50V	W	1012	854	639	465	373	213	151	117	97.1	65.6	53.9	28.0
	A	91.3	76.4	56.5	40.7	32.3	18.1	12.9	10.0	8.30	5.63	4.64	2.41
10.20V	W	1057	877	655	475	379	213	153	118	98.1	66.3	54.5	28.3
	A	97.5	80.2	59.0	42.1	33.3	18.6	13.2	10.2	8.45	5.72	4.71	2.44
10.02V	W	1072	884	658	477	380	214	153	119	98.6	66.6	54.7	28.4
	A	100	81.7	59.9	42.6	33.6	18.7	13.2	10.3	8.49	5.74	4.73	2.45
9.60V	W	1106	896	666	479	382	218	156	121	100.1	67.6	55.6	28.9
	A	107	85.7	62.3	44.0	34.5	19.1	13.4	10.4	8.58	5.79	4.76	2.47

引出端子和接續桿不適合高率放電(30 分率以上) · 如果客戶有高率使用請聯繫本公司。

Leading terminal and connector bar will be not suitable for high rate discharge (over 30MR). If customers have high rate application, Please contact us.

特性 Characteristics

放電特性 DISCHARGE CHARACTERISTICS

放電曲線 Discharge Characteristics Curves at 25°C

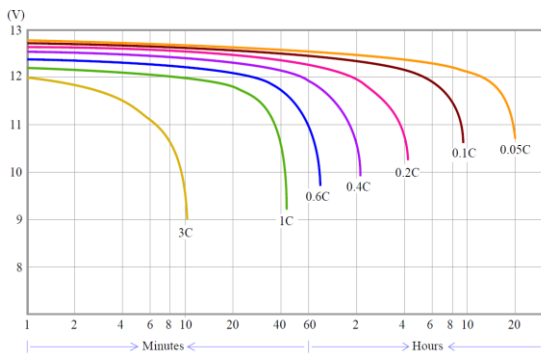

浮充期待壽命 Float Service Life

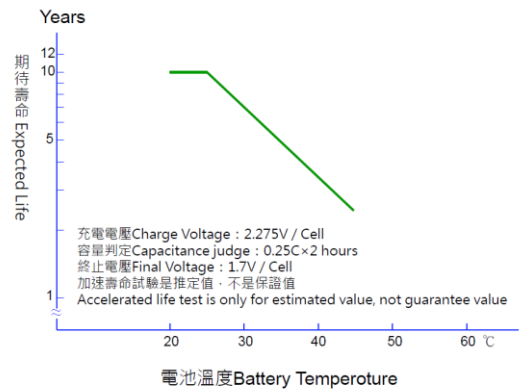

充電特性 CHARGE CHARACTERISTICS

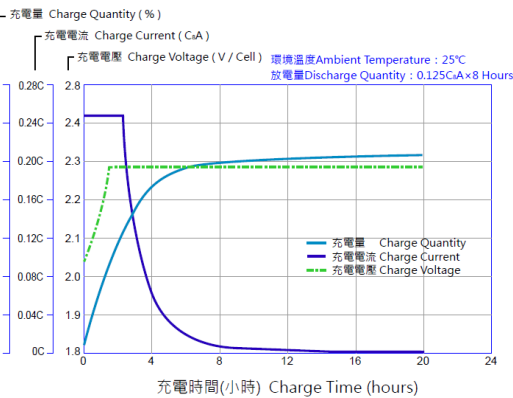

充電電壓 CHARGE VOLTAGE

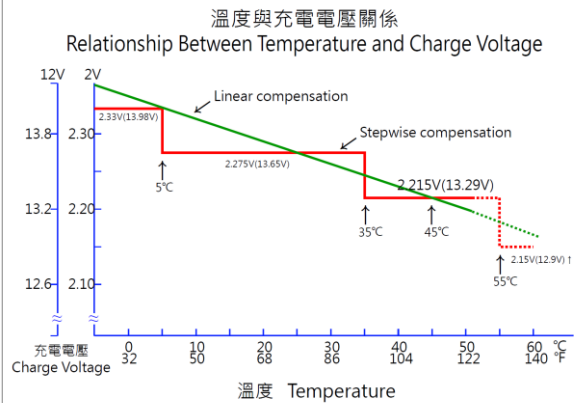

臺灣湯淺電池股份有限公司 新北市新莊區福營路 227 巷 11 號 TEL:(02)2901-8261 FAX:(02)2903-9626
 TAIWAN YUASA BATTERY CO.,LTD No.11, Ln. 227, Fuying Rd., Xinzhuang Dist., New Taipei City <http://www.yuasa.com.tw/>